

Supplement 9 – Fastflat Connectors

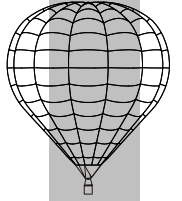

Section 1

1.0 Introduction

This supplement defines the maintenance and inspection requirements for the Fastflat (Stucchi) coupling when fitted to the Ultramagic fuel cylinders and burners.

Sections 1 to 5 detail the maintenance procedures and the parts used. Section 6 details the annual / 100 hour inspection and test requirements.

Connection of the burner to the fuel cylinder is achieved through the use of a special self-sealing coupling. The 3/8" BSP Fastflat connector is offered as an optional fit.

The Airworthiness Limitations section is FAA approved and specifies maintenance required under §§43.16 and 91.403 of the Federal Aviation Regulations unless an alternative program has been FAA approved.

For US operations, only the items listed in 14 CFR Part 43, Appendix A may be accomplished as Preventative Maintenance items.

For U.S. operations, maintenance must be performed in accordance with the requirements of 14 CFR Part 43.3 Persons authorized to Perform Maintenance, Preventative Maintenance, Rebuilding, and Alterations.

For US operations please refer to Unit Conversion Table (Supplement 10), whenever necessary.

1.1 Applicability

The Fastflat coupling may be fitted to all Ultramagic burners and standard fuel cylinders.

1.2 Replacement Parts and Procedures

See Maintenance Manual.

1.3 Approved Maintenance and Inspection Personnel

See Maintenance Manual.

1.4 Welding and Welders

See Maintenance Manual

1.5 Maintenance Reports

See Maintenance Manual.

1.6 Technical Support

See Maintenance Manual.

1.7 Safety

See Maintenance Manual

Section 2

2.0 Airworthiness Limitations

2.1 Approval Statement

This supplement provides the maintenance information for the optional fit Fastflat Coupling as fitted to the Ultramagic burners and fuel cylinders, as required by EASA CS 31 HB.82 and FAR 31 section 31.82.

2.2 Mandatory Replacement Time

See Maintenance Manual.

2.3 Inspection Interval

See Maintenance Manual.

Section 3

3.0 Technical Description

The 3/8" BSP Fastflat connector may be fitted to the fuel cylinder main liquid valve and to the burner fuel hoses as an alternative to the 1 1/4" Acme (Rego) or Tema 3800. Note that all balloon cylinder and burner connectors must be of the same type.

The male connector is fitted to the fuel cylinder main liquid valve and the seal is achieved with the use of a bonded washer. The female connector is fitted to the burner fuel hose and the seal is achieved again with the use of a bonded washer. The coupling is quick-release and self-sealing.

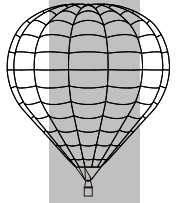

Section 4

4.0 Preventative Maintenance

See Maintenance Manual.

Section 5

5.0 Repair and Maintenance

There are no user serviceable parts in the Fastflat coupling and as such maintenance is limited to replacement only. Removal and replacement of the male and female connectors is generally as described in the relevant sections of the Maintenance Manual. Refer to Figure 1 below for a description of the parts.

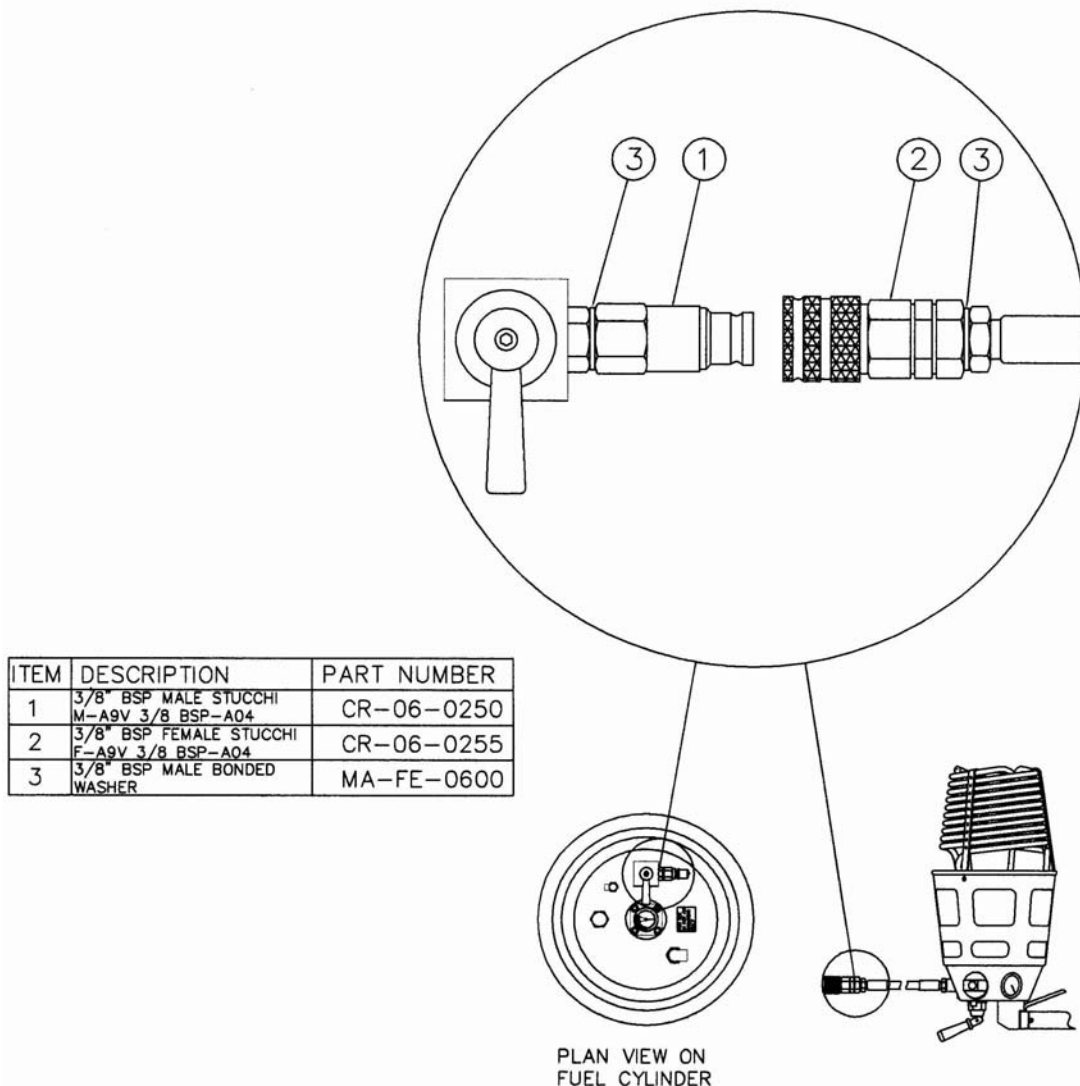
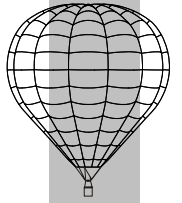
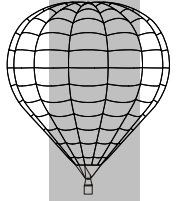

Figure 1
Fastflat Coupling Attachment to Cylinder and Burner





Section 6

6.0 Annual / 100 Hour Inspection Requirements

See maintenance manual.

Section 7

7.0 Troubleshooting

Symptom	Possible Cause	Corrective Action
No fuel flow through connector	Cylinder main fuel valve is OFF position	<i>Turn on main fuel valve</i>
Mated coupling leaks	Male or female or both couplings damaged	<i>Replace</i>
Male connector will not seal	Connector damaged	<i>Replace</i>
Female connector will not seal	Connector damaged	<i>Replace</i>

Section 8

8.0 Post Hard Landing Inspection Requirements

In the event that the equipment is subject to a hard landing, check the mated coupling for leaks and each half of the connector when disconnected from each other to make sure they continue to maintain perfect seals. In addition, check the joint between the male connector and the cylinder main fuel valve to ensure that there is no damage and that it is secure.